



UNIVERSITY OF DELAWARE
CONFERENCE SERVICES

FAQ's for Summer Housing

***The following information addresses many question that summer events typically have.
If you have others, please call us at 302.831.2214***

What campus housing arrangements are provided for summer programs?

Participants for summer programs are housed on the Laird Campus at the University of Delaware.

Room choices are BASED UPON AVAILABILITY: (Please note that Single Rooms are not available. We offer suites only)

- **Room Option 1:** Single Suite: 2 separate rooms with 1 bed per room with a connecting bathroom (limited number available)
- **Room Option 2:** Double Suite: 2 separate rooms with 2 beds per room with a connecting bathroom
- **Room Option 3:** Triple Suite: 2 separate rooms with 3 beds per room with a connecting bathroom

Housing request forms are date stamped upon receipt and rooms are then assigned on a first come first serve basis. The University does its best to accommodate preferences; however, due to popularity, we may not always be able to honor first choices.

Standard Accommodations:

- All rooms have heating/air-conditioning controls, furnished with a desk, chair, wardrobe, and overhead lighting. They have extra-long twin (XLT) beds, 80".
 - We provide linens to 'rent' at the front desk of the Christiana Commons for \$30/set (1 set is: tissue pack, towel, washcloth, bath soap & shampoo, 2 flat sheets, a blanket and pillow with pillowcase).
 - All rooms are cable ready. Should you decide to bring a TV, please be sure to bring all cords needed for connection.
 - Pay-per-use (quarters or flex points) laundry facilities are located in all residential buildings
 - Kitchens and lounges are located in all residential buildings
- * kitchen usage rules apply and must be adhered to per University policy.*

Housing Request/Check-In/Out

A housing request form is located on the University of Delaware Conference Services website

<https://conferences.udel.edu/camps-summer-housing/>

Check-in and check-out dates must be strictly adhered to as the custodial staff must get in and clean the room for the next guest checking in.

You will NOT need a UD ID. Upon arrival, all guests will check in at the Christiana Commons Lobby or Specified Check in location. As a Rule, check-in begins at 2p.m. **unless arrangements for an earlier time have been made and approved by housing manager in advance.** You will get a room key and a key FOB or Access Card at check-in.

Check out is by 11:00am unless arrangements have been made and approved by housing manager in advance.

All room keys, access cards/fobs must be turned in at check out.

How do I register and pay for housing?

Completed housing request forms should be emailed directly to our summer housing manager, on or before April 30th, at matthews@udel.edu.

When will I be notified of my housing assignment?

Housing for your event is arranged through UD Conferences Services. Once Conference Services has received the majority of housing contracts, groups will be placed accordingly. This generally occurs after May 5th.

You will receive an email at the address provided with more information approximately 2-3 weeks prior to check-in.

What do most people do for meals or food?

All programs purchasing dining hall meals or points (for main campus lunches only) may purchase them from the summer housing manager or their event manager (if conference event). We also have a small market, the POD (Provisions on Demand), available with variable hours on Laird Campus in the Pencader Building.

Main Street also offers a vast array of dining choices as well as small grocery, convenience, and drug stores within walking distance.

Refrigerators are not supplied during the summer. If you need to rent a refrigerator please contact 1-800-525-7307. The University does not accept any responsibility for acceptance or pick up of your refrigerators and refrigerators may not be delivered prior to your arrival and must be picked up prior to your departure. It is the responsibility of the person who rents the refrigerators to be sure that the refrigerator is removed prior to their departure. The University has someone moving in the room right behind you so no access is given after departure.

What do you do about parking?

For those living on campus, parking is available near the dorms on Laird (North) Campus. While it is about a 15 minute/1.25 mile walk to, participants may choose to purchase a permit which would allow you access to lots closer to the venue you will be using. Please call Parking Services at (302) 831-1184 or go to their Website to obtain parking passes.

Visit Parking Services at <http://www.udel.edu/transportation/parking/permit-prices.html> to view lot locations and other types of available permits and pricing. Summer Programs are not eligible for Grey Passes.

**Parking meters are never free/University spaces are not to be parked in/
handicap must be displaying handicap tag or license plate and must be registered with the University of Delaware.**

Is there a UD Shuttle Bus?

Yes, UD has free shuttle buses that run from the various locations on-campus. You can go to the link below for shuttle bus information. http://www1.udel.edu/transportation/ud_route/

How do I travel to the University of Delaware by air or car and/or train?

Arriving via Baltimore/Washington International (BWI) or Philadelphia International (PHL) airports will be similarly convenient. PHL is approximately one hour north while BWI is about one hour and 15 minutes south of the I-95 exits to campus. Choose travel to/from the airport that best suits your flight times and finances.

- Two train services are available to bring you to Delaware from PHL: SEPTA (South Eastern Pennsylvania Transportation Authority) and Amtrak.
 - Both rails arrive to the same station in Wilmington, DE, but have different costs.
- Amtrak train service runs full service to Wilmington, DE with limited service directly to Newark, DE.

For travel from the airports or train stations, we suggest Delaware Express at 800.648.5466 or www.delexpress.com. Delaware Express' one-way shuttle from PHL (\$45 without tip) is significantly less expensive than the shuttle from BWI (\$138 WITH tip and tolls) due to their expanded fleet for the PHL-UD run. Mention that you are a UD student for an approximate 5% discount. You do not need to show an ID to get this discount.

There are several rental car companies located near campus. Hertz and Enterprise.

ZipCar is available on campus! (see <http://www.zipcar.com/universities/university-of-delaware> for more info)

Uber & Lyft are also widely available in the area.

Do you recommend having a car while on campus?

Cars can be helpful for things like larger grocery store shopping, department and mall shopping and weekend trips; otherwise, all essentials can be found within walking distance. There is plenty to do on Main Street so you shouldn't feel the need to escape to find entertainment. Outdoor tennis, volleyball, and basketball courts are available for use.

What type of weather should I expect in Delaware in the summer?

Expect generally humid mornings with afternoon temperatures in the mid-high 80's. You should have comfortable evening temperatures. We recommend packing for occasional rain.

What else might I pack or plan to purchase on Main Street upon arrival?

- Hangers
- Sheets (twin xl)
- Reading Lamp
- Blanket
- Surge protector
- Backpack
- Pillow
- Shampoo, soap and other toiletries
- Laundry Basket & detergent
- Bathroom Cleaning Supplies
- Toilet Paper (although you can get more from the Commons front desk)
- Towels

Mail

Mail cannot be delivered directly to the residence halls during the summer months.

Package Deliveries are generally delayed by 2 days in many instances due to transfers from shipper. We recommend that you utilize Amazon Lockers and USPS PO Boxes for summer mail.

Refer to Mail Services for direction on package delivery.

Package Pick up Hours are 8:30am-4pm

Front Desk Hours are 7am-11pm, 7 days a week.

302-831-1245

www.udel.edu/conferences

Room Option 1

Single Suite (very limited number available)

If you request a single suite and only doubles are available, you will pay the double suite rate.

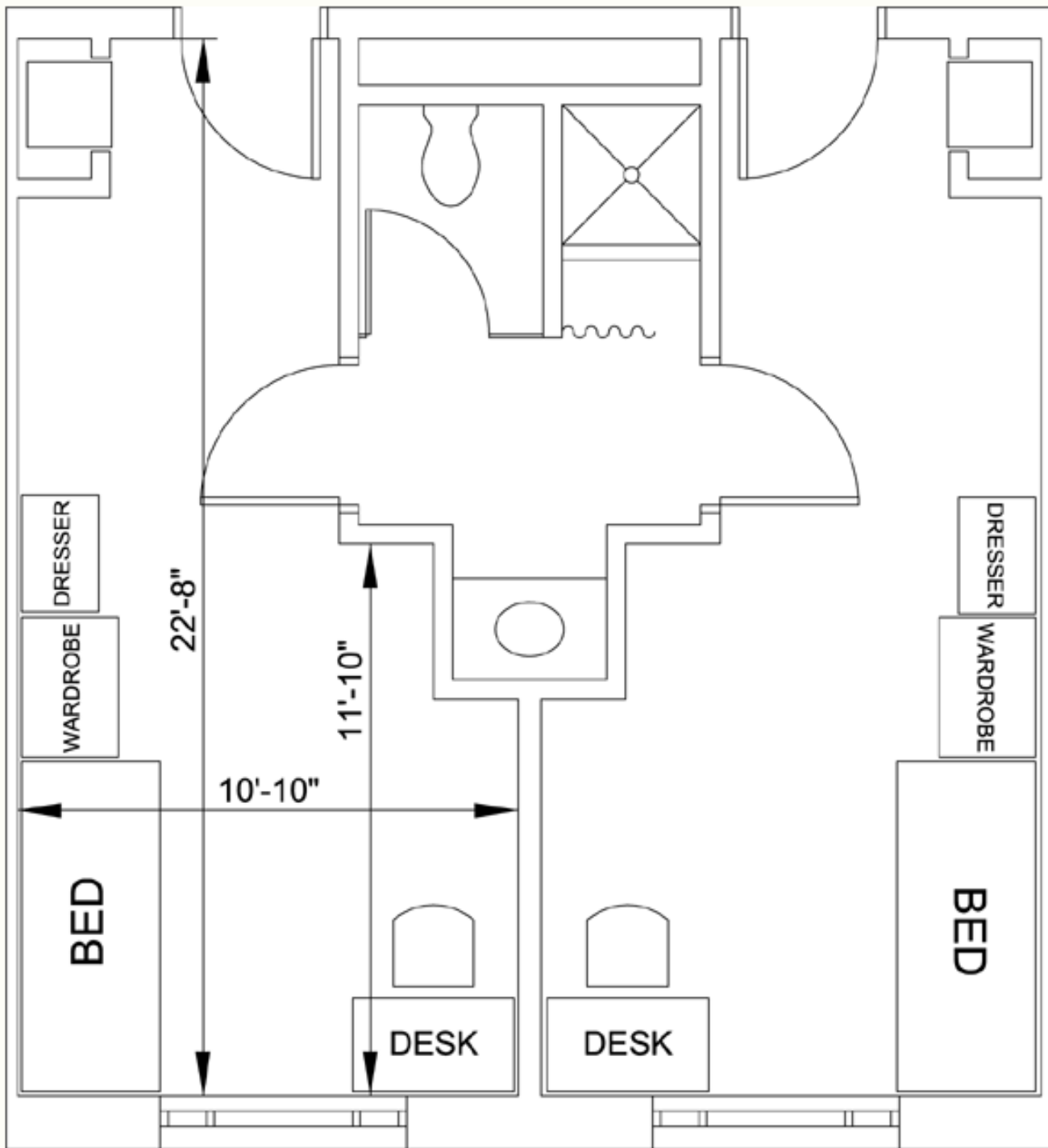

Room Option 2

Double Suite

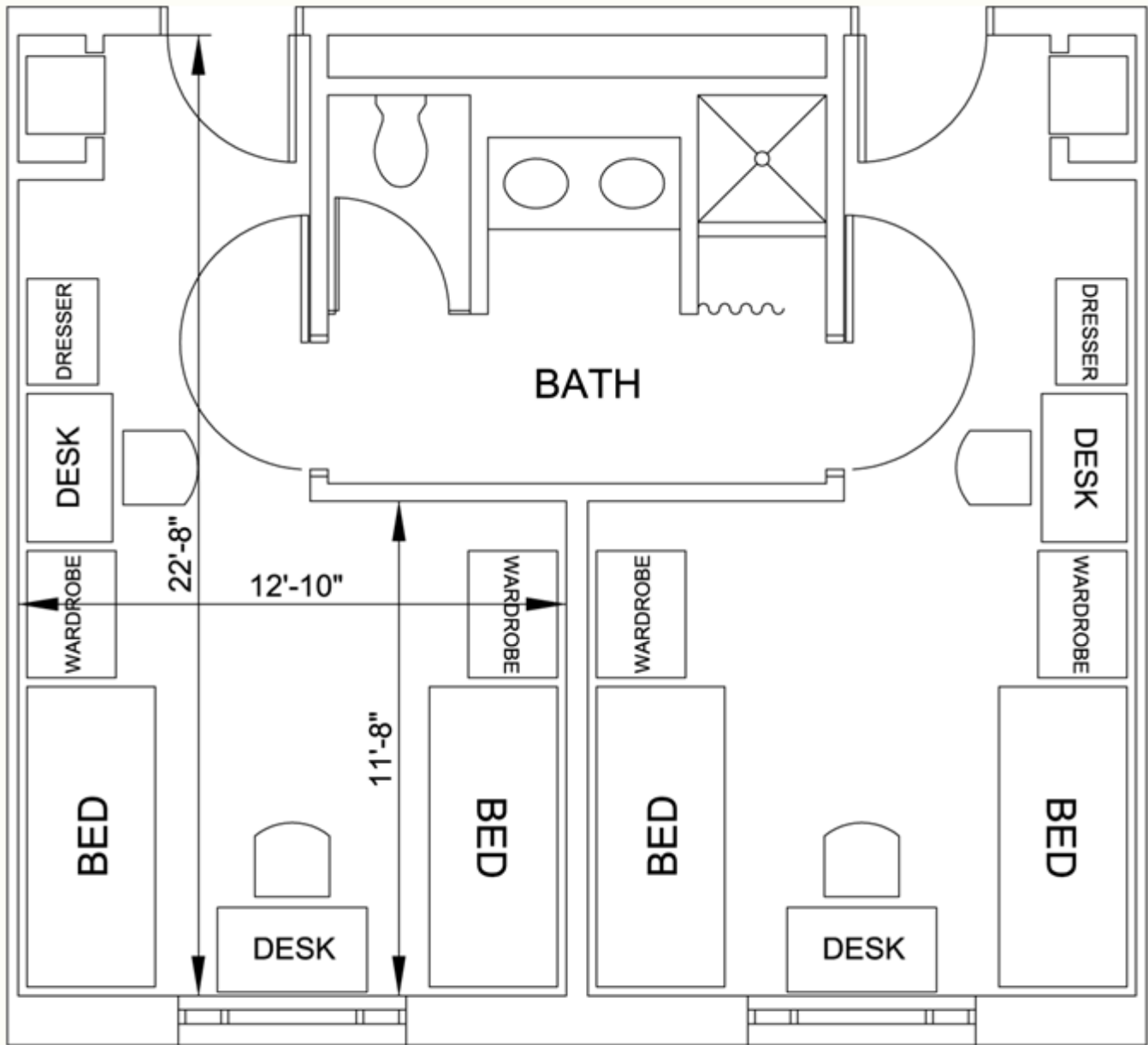

Room Option 3

Triple Suite

The Third bed is generally bunked in the room

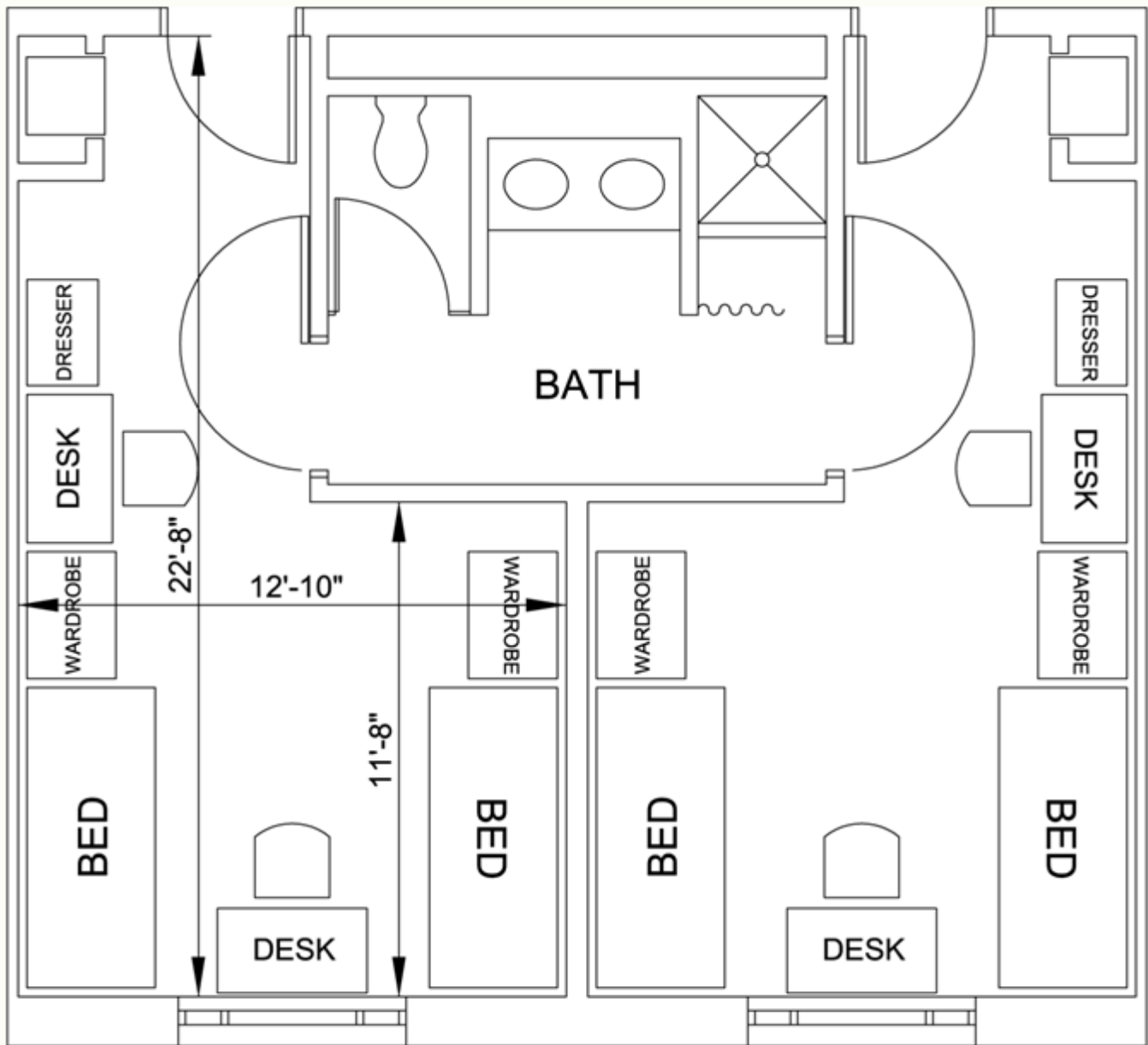

Access Cards/Fobs

Please place your access card or fob against this white sign and listen for the door to unlock then enter the building. *Most Access Panels are marked with small stickers to indicate the sensitive spot.

You should here a small beep followed by a click sound of the door unlocking.

Never put a key in the lock on the entrance doors. Your key is only for your room.

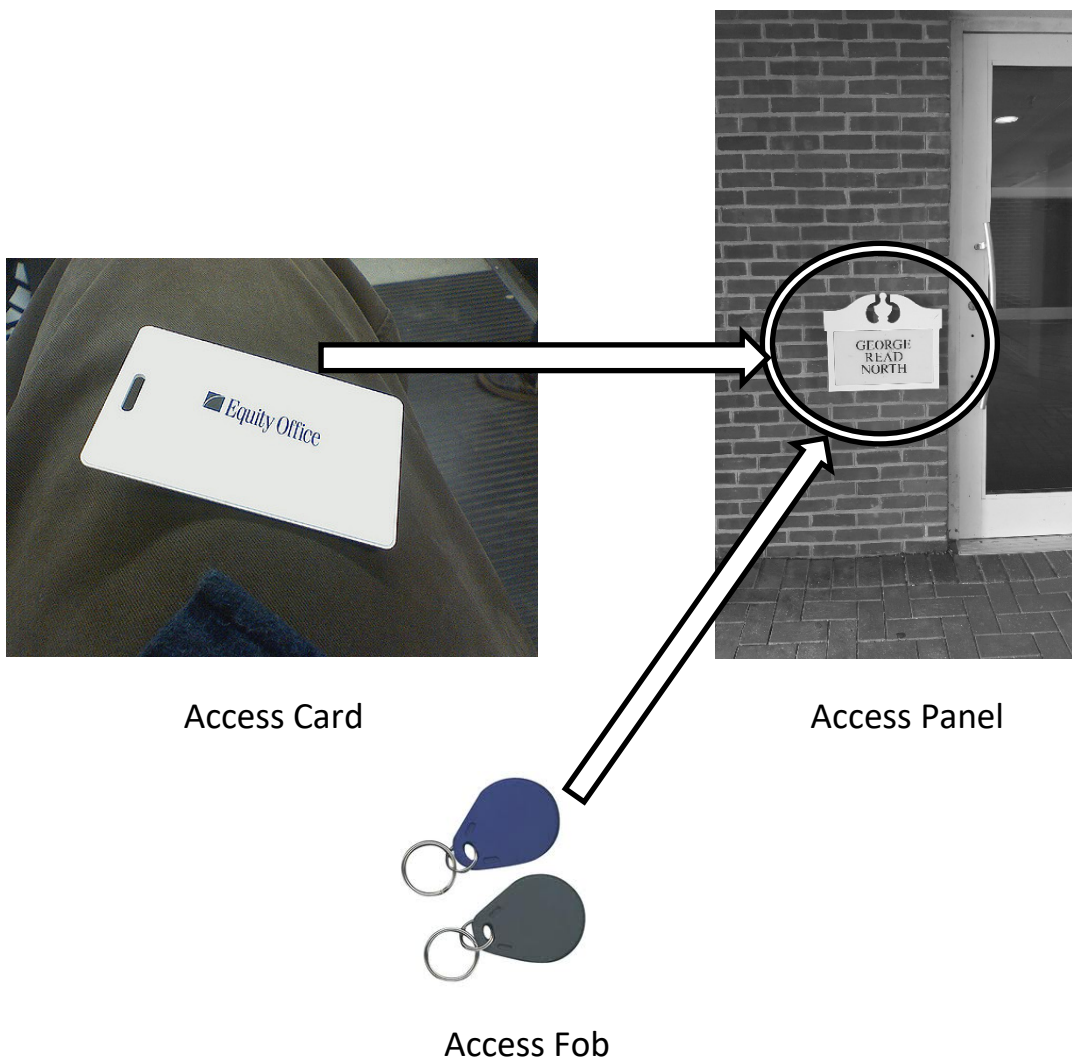

Kitchens and Lounge use Policy

Kitchens and Lounges are NOT eligible for individual or group reservation.

Kitchens are to be used solely for culinary purposes (cooking/food preparation), and all groups are responsible for their own clean up and trash removal.

The University does not provide any kitchen equipment, cleaning supplies, utensils, etc...

Kitchen privileges will be revoked from any group that violates the kitchen use policy.

We do NOT allow you to store any kitchen supplies in the kitchen.

We do NOT allow you to leave food items in the refrigerators for a period of more than 24 hours.

Any food items left in refrigerators will be disposed of.

The University and staff will NOT be held liable for any food, cooking utensils, nor any other items that have been left in the kitchen or not properly disposed of.

ALL trash and waste must be removed from the University premises and properly disposed of in the dumpsters located outside of each building.

If you are with a group that needs refrigerator/freezer storage for a special event, you MUST contact

Summer Housing Manager to ensure that your building Custodial Manager is aware.

Lounges CANNOT be reserved at the University of Delaware unless your group is the only group in the building or on that specific floor. Lounge Fees vary depending on what you are reserving the lounge for.

All lounge space is for the use of the entire building, and no one is permitted to block off, post signs, or in any way prohibit anyone from entering the space.

If you would like to reserve a space for meetings, please contact

Cathy Matthews by email at matthews@udel.edu.

**Meeting spaces are available on Campus
and at Clayton Hall for a fee.**

www.udel.edu/conferences

302-831-2214

Front Desk at Christiana Commons

302-831-1245