



560 Music Center

 Washington University in St. Louis

Wedding Rental Information Packet



Ballroom Theatre

Features a terrazzo floor and a Steinway Piano, the venue can accommodate up to 200 guests (seated at round tables). The spacious room allows for a variety of layouts. The perfect fit for your wedding reception.



Renting the Ballroom:

The 560 Music Center charges a flat rate of **\$3,000** for Wedding Reception rental. The Following are **included** in that fee:

- Up to 10 hours of space usage for the day
- Use of round tables and chairs (24 Round tables – seat up to 10 persons)
- Use of rectangular tables (5@ 8', 5 @ 6')
- Use of the Catering Kitchen (*Not equipped with stove or ovens*)
- Table layout set up prior to client's arrival
- Use of Steinway Grand Piano (Must stay in room even if not being utilized)
- Security Guard fee
- Janitorial Staff fee
- Fee for \$1,000,000 Liability insurance (provided to you through Washington University)
- A day of Event Supervisor (560 Staff Member)
- Bridal Suite/Dressing room
- Parking space in the rear for up to 60 cars

The 560 Music Center does **NOT provide** the following:

- Linens for tables
- Lighting equipment

Other Information:

Payment Schedule- A deposit of \$1500 is **due upon signing** of contract to reserve the space; the remainder of the fee is due **one month prior** to event date (at preliminary meeting)

Preliminary Meeting- The client will be required to have a meeting with a 560 Music Center staff member to discuss the details and timeline of the event one month prior to the date.

Vendor Requirements- The 560 Music Center does NOT have a list of preferred vendors. A Client may bring in whatever design, floral, or catering company they desire; as long as there is a schedule of arrival provided beforehand.

*Annually, 560 Music Center reserves the right to change charges as it deems appropriate. 560 Music Center has the sole right to determine who shall/shall not use the FACILITY.

Ballroom Theatre Specifications

Large open ballroom, Art Deco style, features a terrazzo floor and historical reproduction chandeliers and sconce lighting. Entrance is via Trinity Ave lobby.



Address: 560 Trinity Ave, St Louis, MO 63130

Capacity: 300 people standing, seated at tables, or theatre style

Accessibility: All entrances are wheelchair accessible. Mechanically assisted doors on east side of Ballroom.

Main Floor Area: 46ft wide x 71ft deep

Stage Dimensions: 25ft wide x 16ft deep; Stage elevation 36" above house floor

Stage Type: Proscenium with black stage curtain, no rigging capabilities or electrical battens.

Stage Floor: Tongue and groove, no traps.

Access: A single side door at stage right and stage left (rear). Two permanent stairs from house level downstage right and left. Stage not handicapped accessible.

Lighting: 24 150-watt PAR38 lamps attached to Viewpoint dimmer operated from stage right. No capacity to alter or add to this dimmer or the attached lights. Dimmable chandeliers and sconces.

Audio: 2 QSC K-12 powered speakers fed by an Allen & Heath Zed 10 mixer, with 4 microphone inputs and two stereo line inputs.

Electrical: 1 20 amp circuit downstage right. 1 20 amp circuit downstage at house level. 1 20 amp circuit with 5 between house left wall and upstage wall. 1 20 amp circuit on house right wall by closet.

Piano: Steinway B grand piano on house level. Requests for tunings or to move piano to stage must be made in advance to Production Coordinator and are at the expense of renter.

Loading: Doors are at street level. Preferred loading entrance on east side of building. Maximum width and height are 58in and 94in.

Support Spaces: Support space availability varies depending on school activity.
3 dressing rooms on second floor with counters and mirrors. 1 external unisex bathroom with two showers across from dressing rooms.

Catering Kitchen: A multi-purpose room (Green Room) located directly behind the Ballroom Theatre provides preparation space. Deep well sink, no oven, stove, fryer, etc. Dedicated 20amp circuit for food warmers.

Building Ground Plan

560 Music Center
Washington University in St. Louis

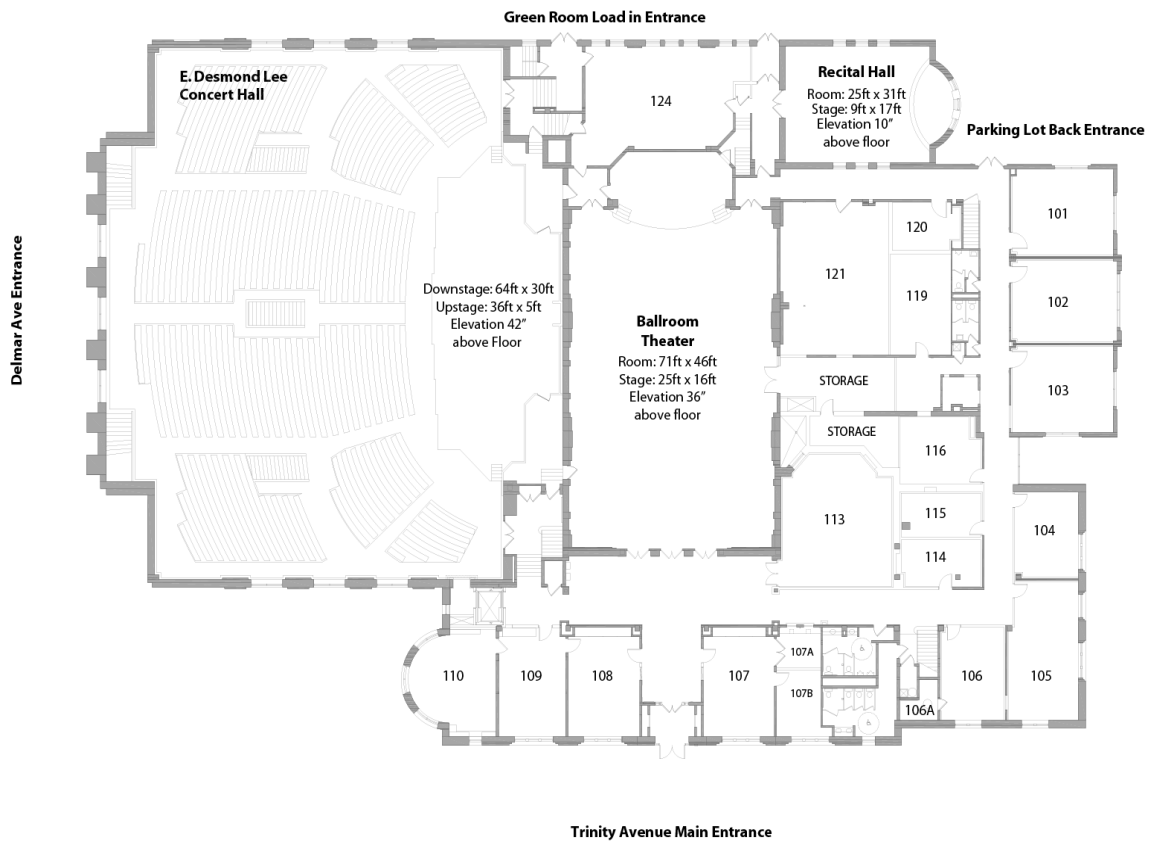

Dressing Room



Included Equipment List

Tables:

Cabaret Tables (3' diameter, adjustable height) - **12**

Large Rounds (6' diameter, seat 8-10 people) - **24**

Rectangular Folding (6' long) - **5**

Rectangular Folding (8' long) - **5**

- Black skirting for rectangular tables available upon request. 560 does not have any linens in house.

Chairs:

Green Upholstered Banquet Chairs- **300**

Music Stands:

Manhasset #48- **75**

Lighting :

Source4 ParNel- 6, with floor stands

LED Colorado Zoom4- 9, permanently focused to stage and floor in front.

Control- Touch screen panel, pre-programmed looks.

Staging:

Wenger Conductor Podium- **1**

Oak Lecturn- **1**

10' Boom and pole- **2**

Pipe and drape-

- 4 X 16 black velour Drape- **16**
- Adjustable uprights 9'-16'- **6**
- Base with pin- **6**
- Telescoping crossbar 7',10',12'- **4**

Audio :

Shure SM58 Dynamic cardioid vocal microphone Quantity-4

Shure SLX Wireless Microphone System Quantity-1

- 2 handheld
- 2 lavalier body pack

***For more information or to schedule a tour, please contact:**

Bess Moynihan- Production Coordinator (314) 935-2926
Bess.moynihan@wustl.edu

Street Address:

560 Trinity Ave.
St. Louis, MO 63130