

## Cupples (Samuel) II (112)



### Accessible Entrance(s)





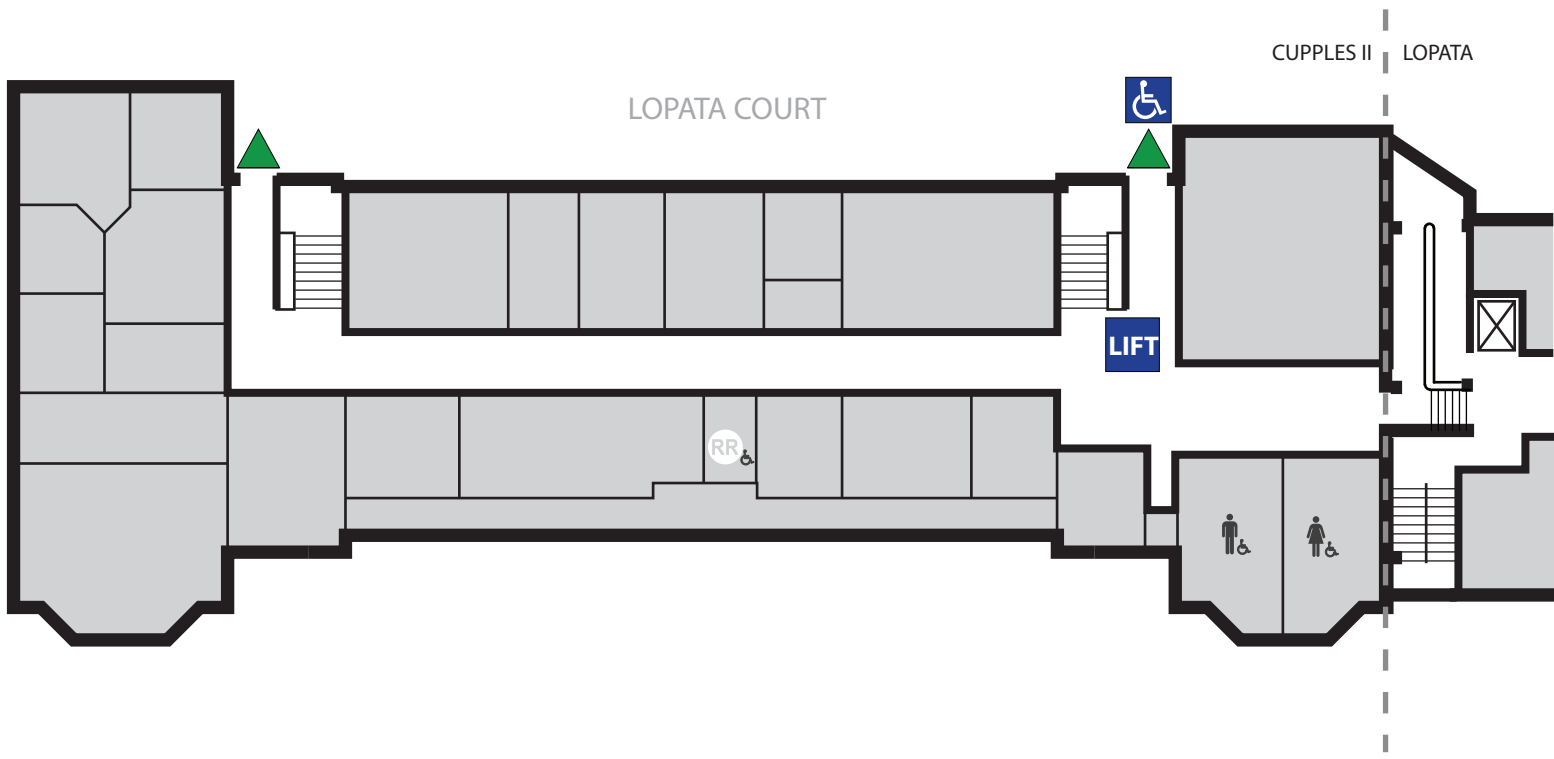

Southwest entrance. Northwest entrance accessible and linked to central hallway through 001 classroom. Northeast entrance is accessible to 015 classroom.

<b>Power Assist Doors</b>	Southwest
<b>Accessible Restrooms</b>	LL, 2nd, 3rd
<b>Elevators</b>	Yes
<b>Chair Lifts</b>	Northeast LL
<b>Braille</b>	Yes

# CUPPLES II HALL LOWER LEVEL (112)



**LEGEND**

 EXITS	 ELEVATOR
 ACCESSIBLE ENTRANCE	 CHAIR LIFT
 ACCESSIBLE RESTROOM	 GENDER INCLUSIVE RESTROOM



# CAMPUS ACCESSIBILITY MAP

# CUPPLES II HALL LEVEL 1 (112)

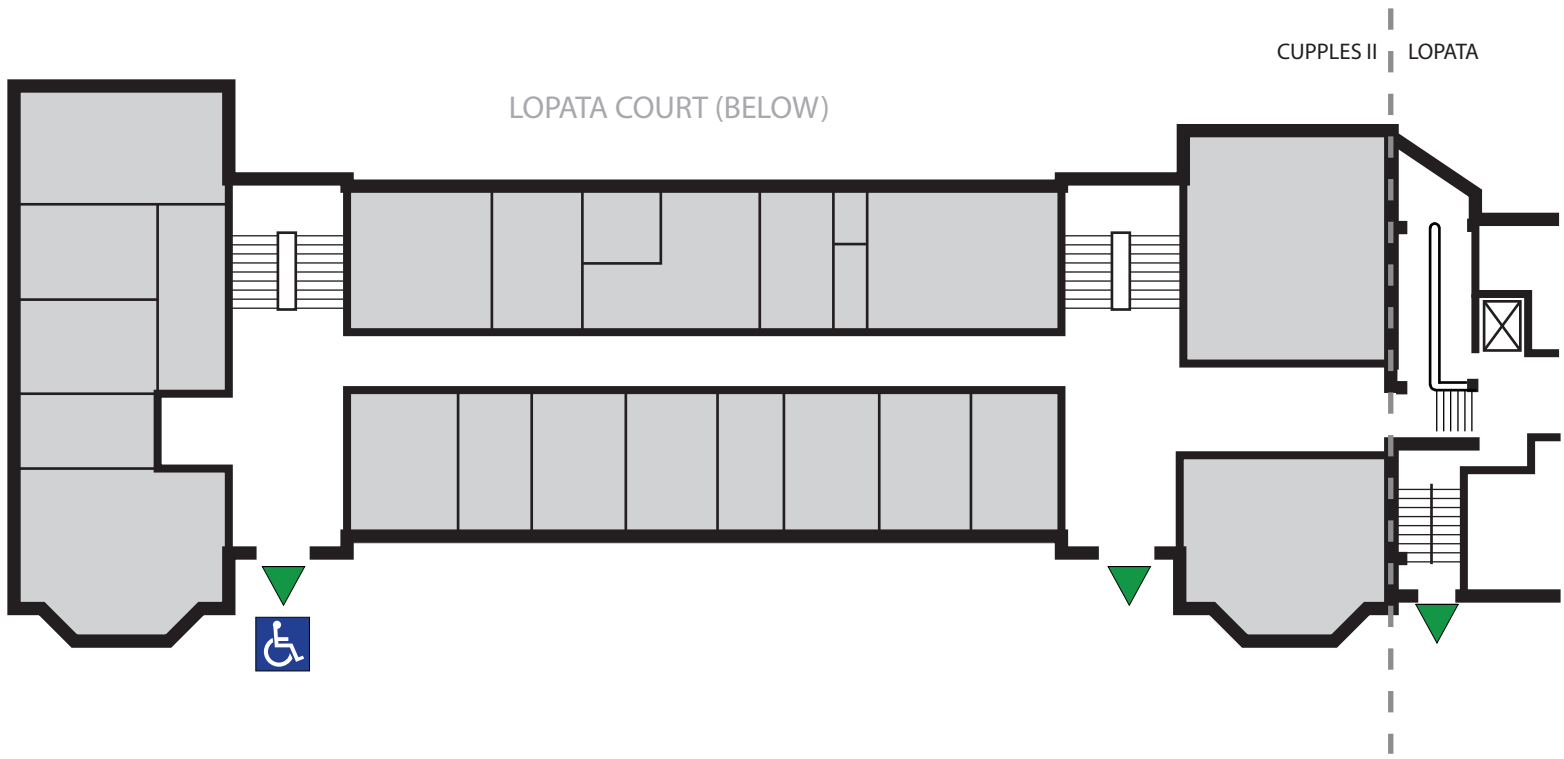

**LEGEND**

-  EXITS
-  ACCESSIBLE ENTRANCE
-  ACCESSIBLE RESTROOM
-  ELEVATOR



CAMPUS ACCESSIBILITY MAP

# CUPPLES II HALL LEVEL 2 (112)

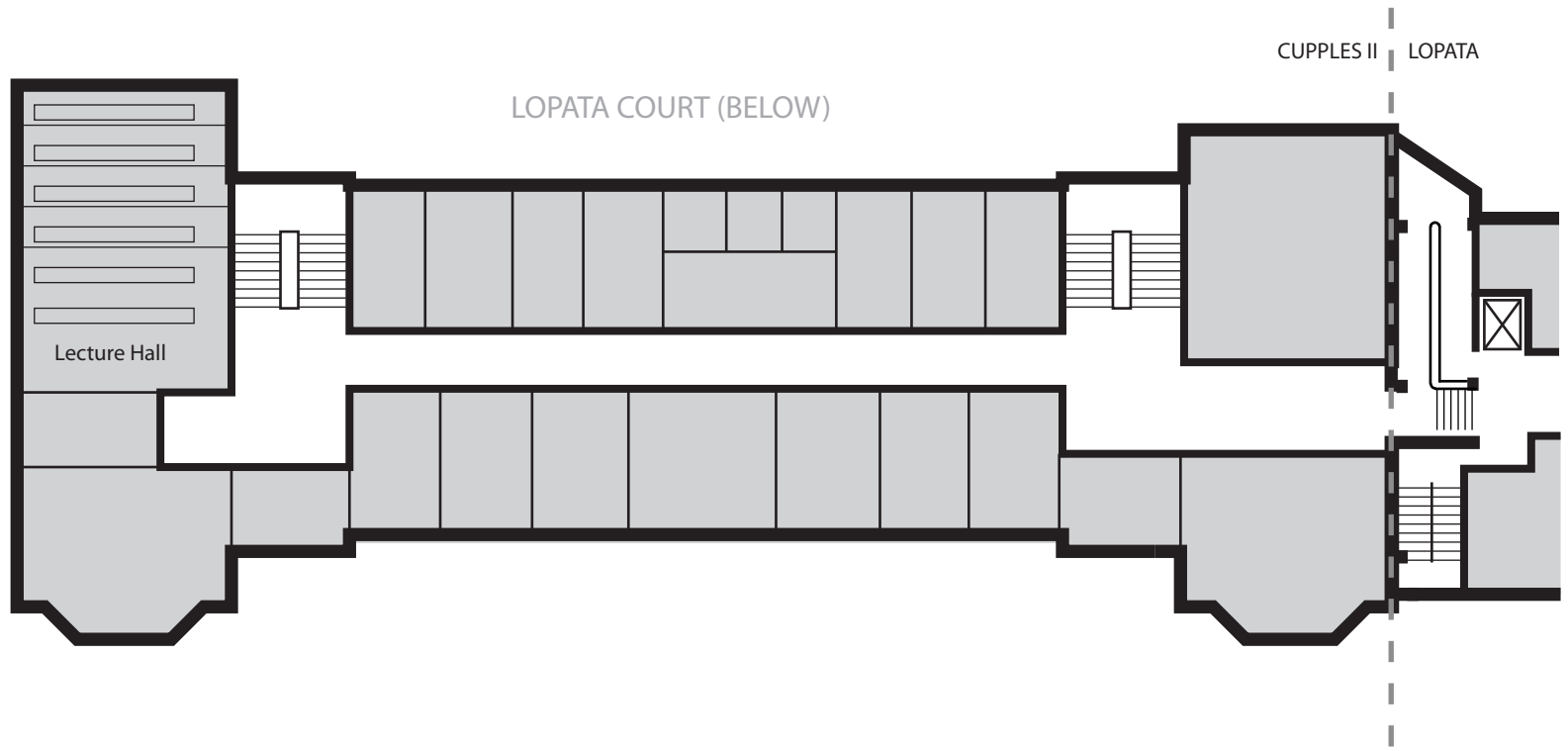

**LEGEND**

-  EXITS
-  ACCESSIBLE ENTRANCE
-  ACCESSIBLE RESTROOM
-  ELEVATOR



# CAMPUS ACCESSIBILITY MAP

# CUPPLES II HALL LEVEL 3 (112)

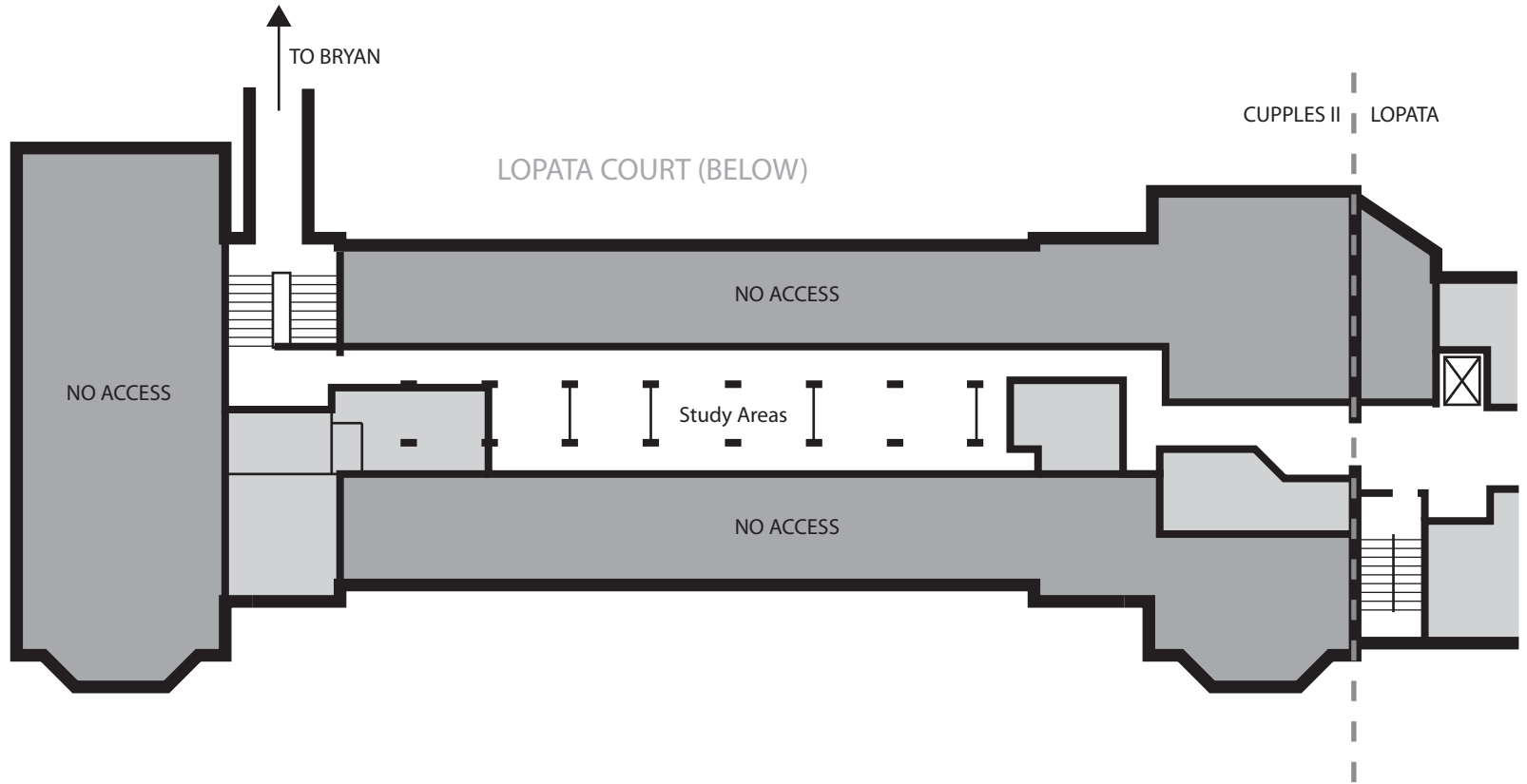

**LEGEND**

-  EXITS
-  ACCESSIBLE ENTRANCE
-  ACCESSIBLE RESTROOM
-  ELEVATOR

