

Estimate of land (in acres) between border barriers and the Rio Grande River in Texas

	Built	Proposed	Total
Val Verde County	593	n/a	593
Maverick County	182	n/a	182
Webb County	77	n/a	77
Starr County	n/a	5,971	5,971
Hidalgo County	10,239	13,789	24,028
Cameron County	12,478	n/a	12,478
TOTAL of these six counties	23,569	19,760	43,329

Estimate of land between border barriers and the Rio Grande River in
Val Verde, Maverick, and Webb Counties, Texas
 approximately 852 acres built

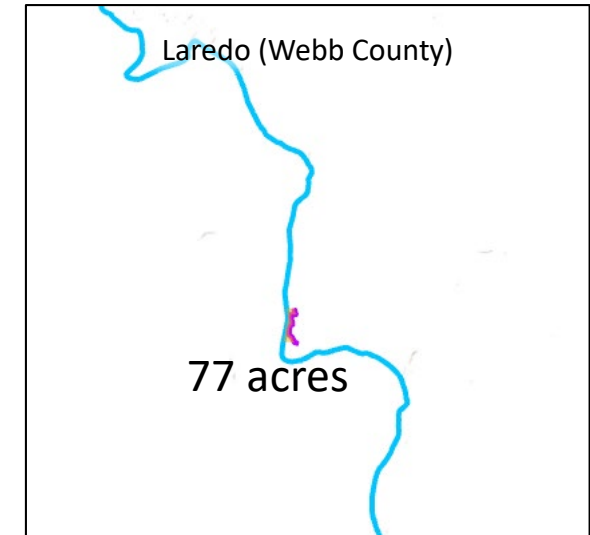
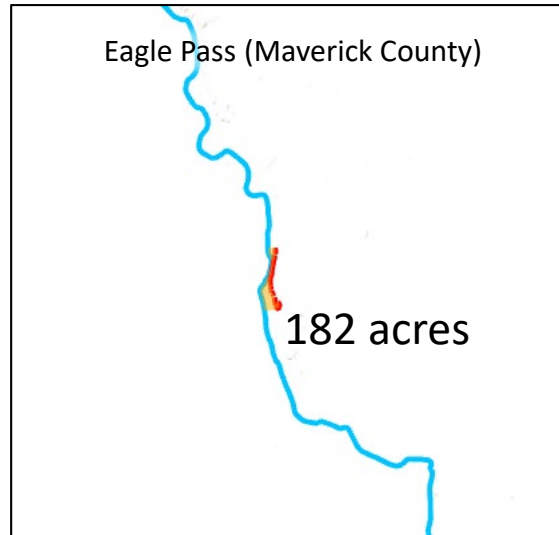
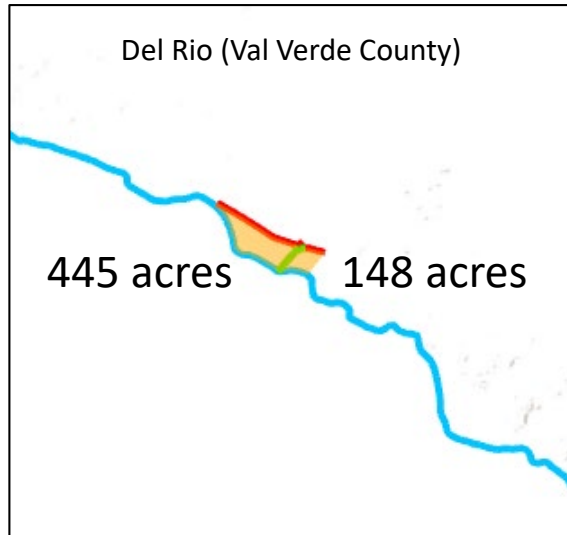

4 miles 4 km

 land behind barriers already built

includes land behind GAPS or GATES in the walls
 includes POE walls when serving as gaps between CBP walls
 based on line drawn from the closest point between wall and river
 this does not necessarily reflect effective access to land behind barriers
 property privacy fences, roads, and other features would impact actual ease of access
 measurement is to middle of the river



Kenneth D. Madsen
 Associate Professor of Geography
<http://u.osu.edu/madsen.34/maps/>

Estimate of land between border barriers and the Rio Grande River in
Starr County, Texas
approximately 5,971 acres proposed



Kenneth D. Madsen
Associate Professor of Geography
<http://u.osu.edu/madsen.34/maps/>

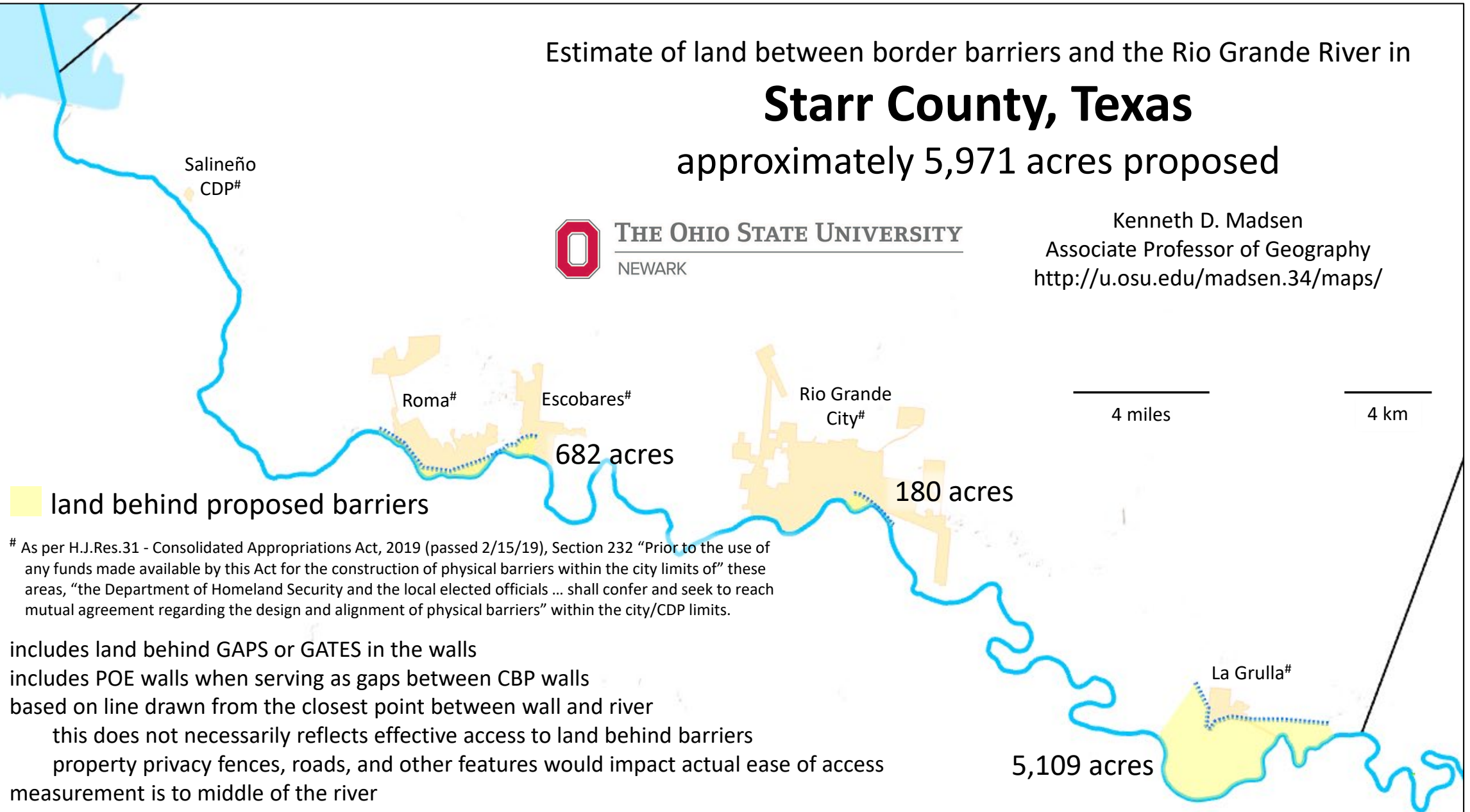

As per H.J.Res.31 - Consolidated Appropriations Act, 2019 (passed 2/15/19), Section 232 "Prior to the use of any funds made available by this Act for the construction of physical barriers within the city limits of" these areas, "the Department of Homeland Security and the local elected officials ... shall confer and seek to reach mutual agreement regarding the design and alignment of physical barriers" within the city/CDP limits.

includes land behind GAPS or GATES in the walls
includes POE walls when serving as gaps between CBP walls
based on line drawn from the closest point between wall and river
this does not necessarily reflect effective access to land behind barriers
property privacy fences, roads, and other features would impact actual ease of access
measurement is to middle of the river

CDP = Census Designated Place, an unincorporated community

Estimate of land between border barriers and the Rio Grande River in

Hidalgo County, Texas

approximately 10,239 acres built
+ 13,789 acres proposed

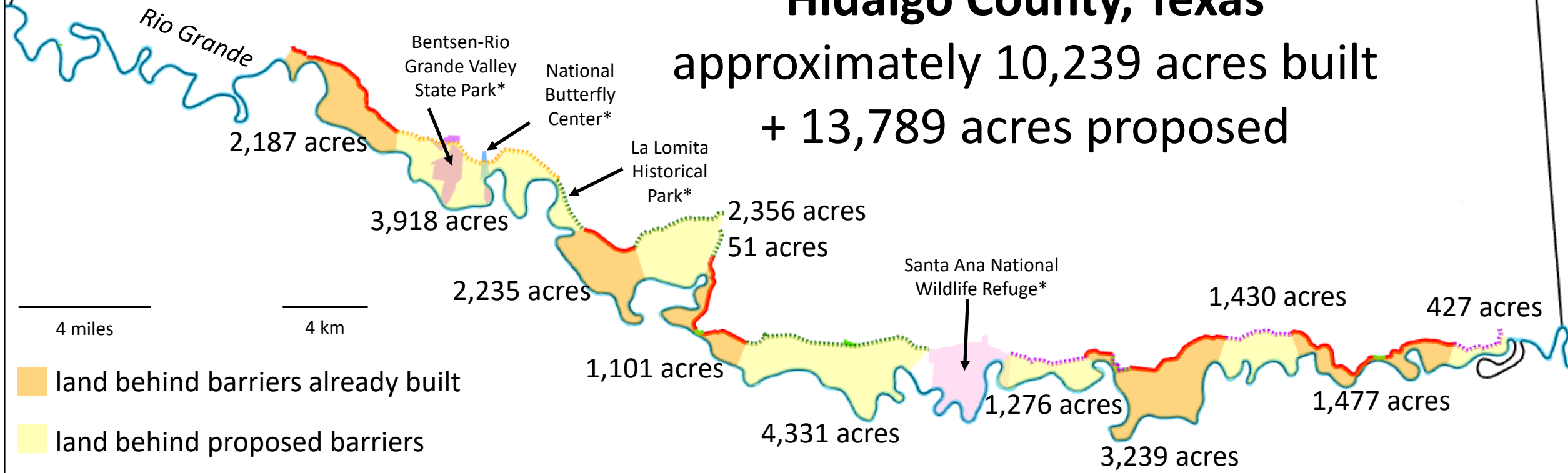

* As per H.J.Res.31 - Consolidated Appropriations Act, 2019 (passed 2/15/19), Section 231 "None of the funds made available by this Act or prior Acts are available for construction of pedestrian fencing" within this area.

includes land behind GAPS or GATES in the walls
includes POE walls when serving as gaps between CBP walls
based on line drawn from the closest point between wall and river
this does not necessarily reflect effective access to land behind barriers
property privacy fences, roads, and other features would impact actual ease of access
measurement is to middle of the river



THE OHIO STATE UNIVERSITY
NEWARK

Kenneth D. Madsen
Associate Professor of Geography
<http://u.osu.edu/madsen.34/maps/>

Estimate of land between border barriers and the Rio Grande River in

Cameron County, Texas

approximately 12,478 acres built

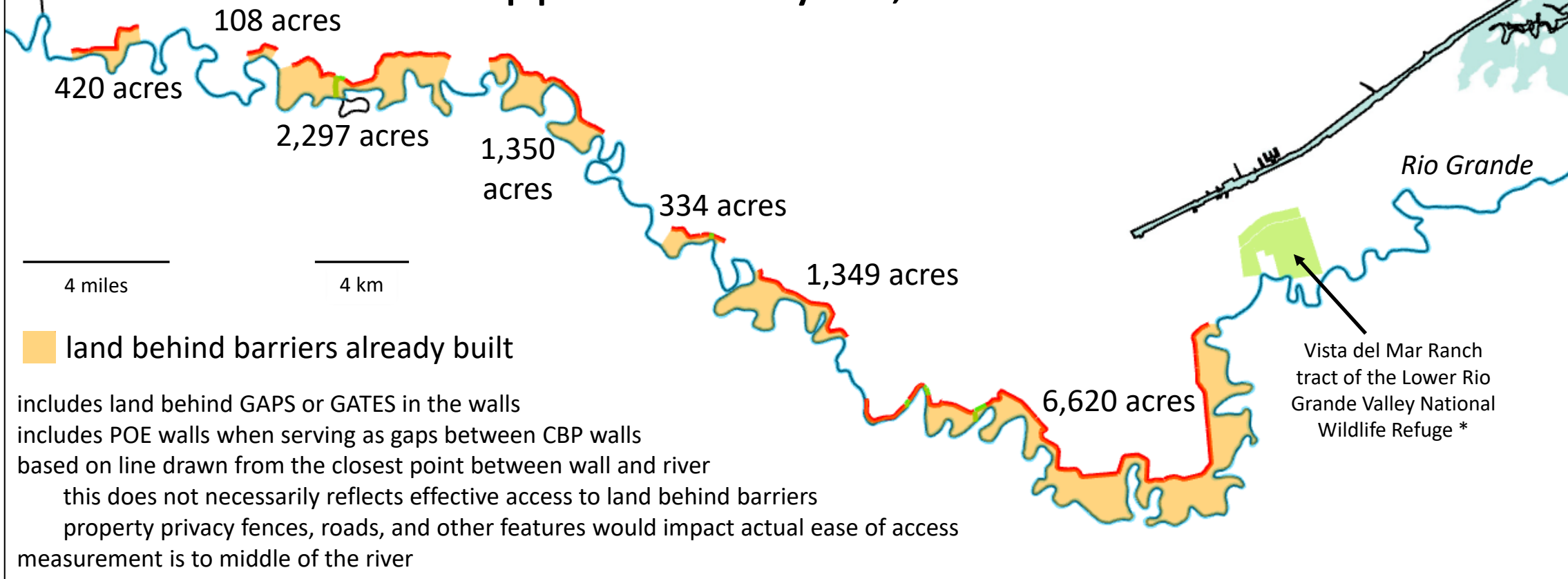

Additional Statistics for Starr County, Texas:

river border = 68.9 miles

total length of DHS waiver coverage = 13.7 miles

(all described as along river, no duplication)

border covered by DHS waivers = approx. 13.7 miles or 20%

There are currently no border barriers in Starr County other than POE fencing

total length of barriers proposed May 2018 = 11.8 miles

(by my estimate based on CBP map, 8 miles per CBP narrative)

Additional Statistics for Hidalgo County, Texas:

river border = 96.2 miles

total length of DHS waiver coverage = 35.4 miles

total length of DHS waivers, including duplicates = 38.6 miles

border covered by DHS waivers = approx. 62.5 miles or 65%

(measured by shortest line from end of each waiver to river bank)

total length of PF225 barriers = 20.0 miles

total length of POE barriers = 2.3 miles

total length of barriers proposed May 2018 = 24.4 miles

(by my estimate based on CBP map, 25 miles per CBP narrative)

Additional Statistics for Cameron County, Texas:

river border = 117.6 miles

total length of DHS waiver coverage = 37.0 miles

total length of DHS waivers, including duplicates = 42.7 miles

border covered by DHS waivers = approx. 70.1 miles or 59.6%

(measured by shortest line from end of each waiver to river bank)

total length of PF225 barriers = 34.4 miles

total length of POE barriers = 3.1 miles

Disclaimer: The maps and data here were prepared with great care and a focus on accurate representation. Nonetheless, they are meant for academic research and general reference rather than definitive legal purposes. Factors that impact the final layout and accuracy include (for example): base map, data layers, judgement calls and interpretations when conflicts or unclear data was encountered, rounding, level of source detail, and map projection. Map projection used for these maps was adapted from USA Contiguous Equidistant Conic with a focus on the border region and a central meridian of 107° 08' W.

Data Acknowledgements: ESRI, Google Maps/Earth, MapQuest, Hidalgo County Appraisal District, International Boundary and Water Commission, U.S. Department of Homeland Security, Texas Parks & Wildlife, Texas Natural Resources Information System, University of Arizona Spatial Data Explorer, DataBasin, *Federal Register*, Sierra Club Borderlands, Defenders of Wildlife, Texas Civil Rights Project, Denise L. Gilman, Dan Millis, Scott Nicol, Bryan Bird, Matt Clark. My apologies for any inadvertent omissions.

See website for additional maps of the area.



Kenneth D. Madsen
Associate Professor of Geography
<http://u.osu.edu/madsen.34/maps/>