

Speed D8ers R19

Engineering 1282H
Spring 2018

Justin Banke
Jack McGinness
Kelly Meaden
Colby Williams

RJF Mon/Wed/Fri 10:20

Date of Submission: 04/16/18

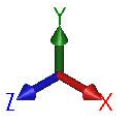
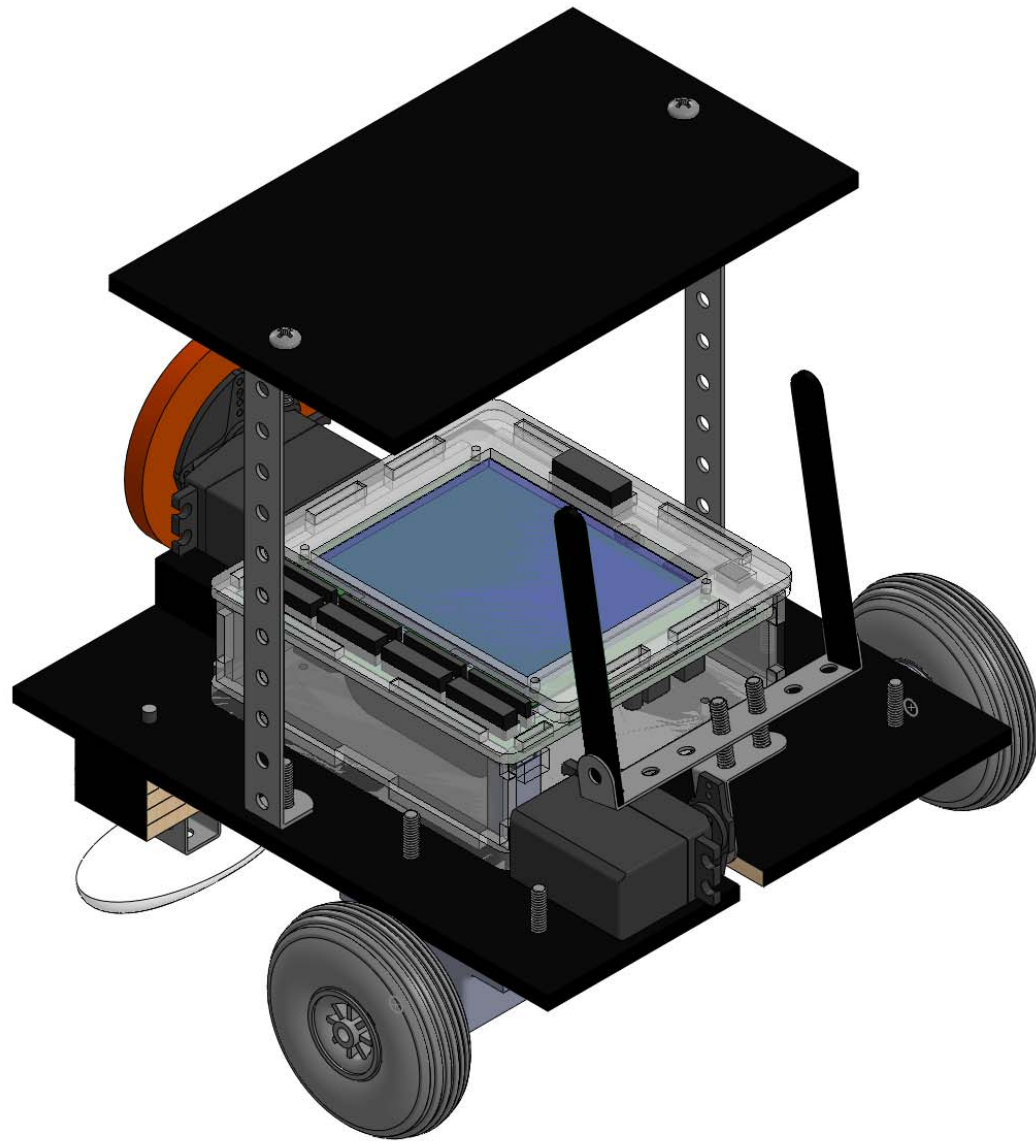

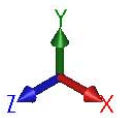
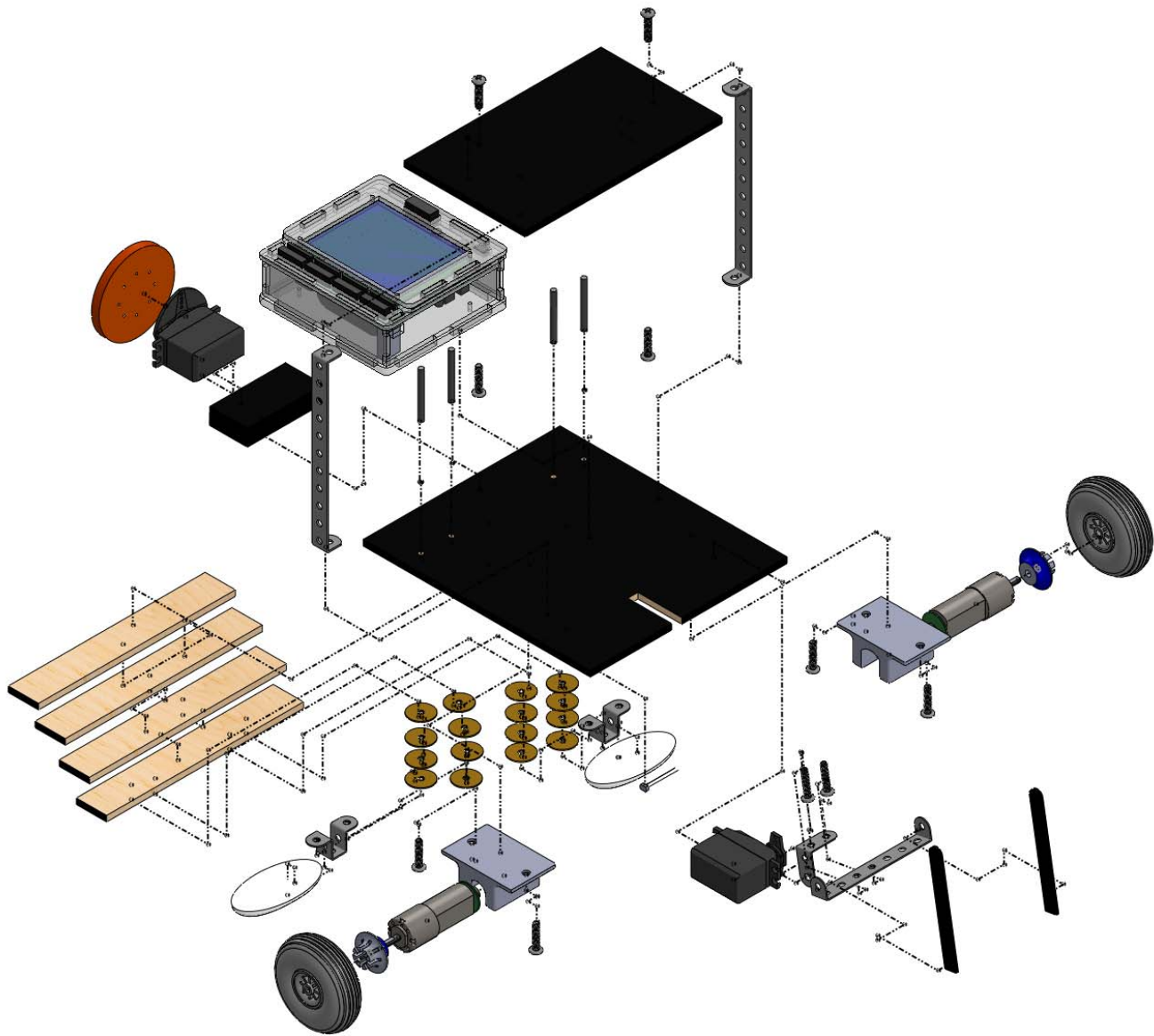

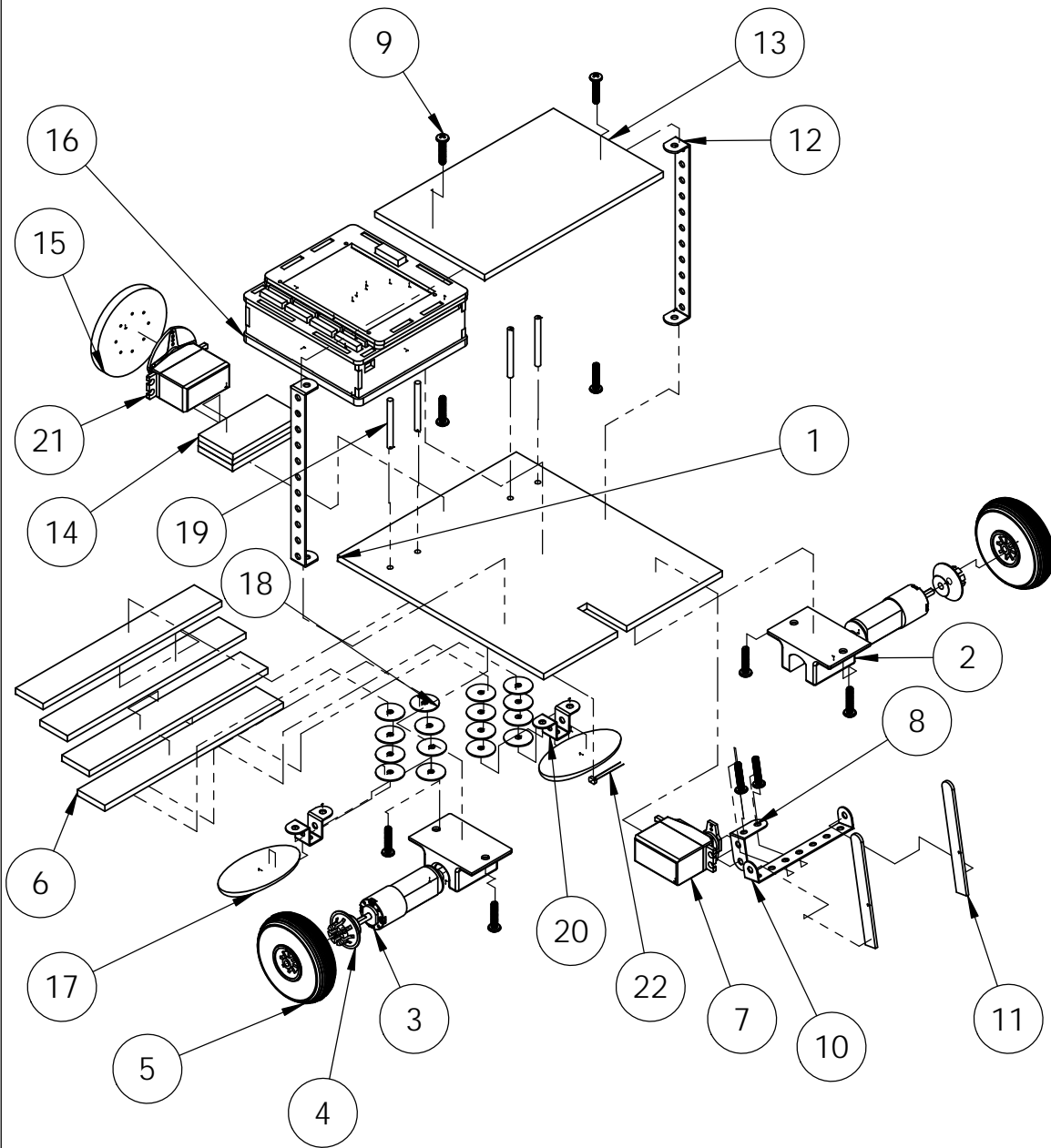

ITEM NO.	PART NAME	MATERIAL	QTY.
1	MDFWoodBody	PLYWOOD	1
2	Iguan Robot Mount	ABS PLASTIC	2
3	IGWAN Motor	STEEL	2
4	IGWAN Wheel Adapter	ABS PLASTIC	2
5	Wheel 2.5"	RUBBER	2
6	MDFWood Skid Stack	PLYWOOD	4
7	futabaServo For Arms	STEEL	1
8	Angle Bracket 2x2	STEEL	1
9	SCREW04	STEEL	10
10	Double Angle Strip 1x7x1	STEEL	1
11	Popsicle Stick	PLYWOOD	2
12	Double Angle Strip 1x11x1	STEEL	2
13	MDFWood3DPrintedMount	PLYWOOD	1
14	MDFCrankMount	PLYWOOD	3
15	3D Printed Crank Wheel	ABS PLASTIC	1
16	PROTEUS	VARIOUS	1
17	Spoon Skids	PLASTIC	2
18	washer	COPPER	16
19	Screwed Rod	STEEL	4
20	Double Bent Strip	STEEL	2
21	futabaServo For Crank	STEEL	1
22	CDS Sensor	STEEL	1

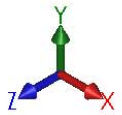
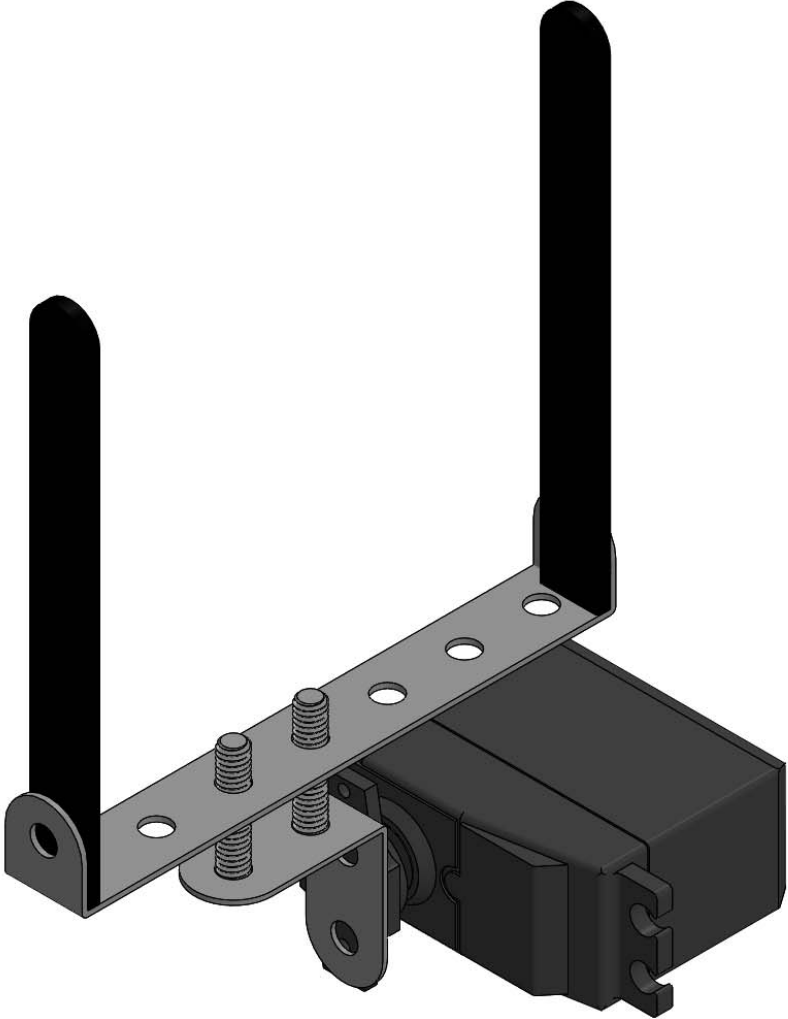

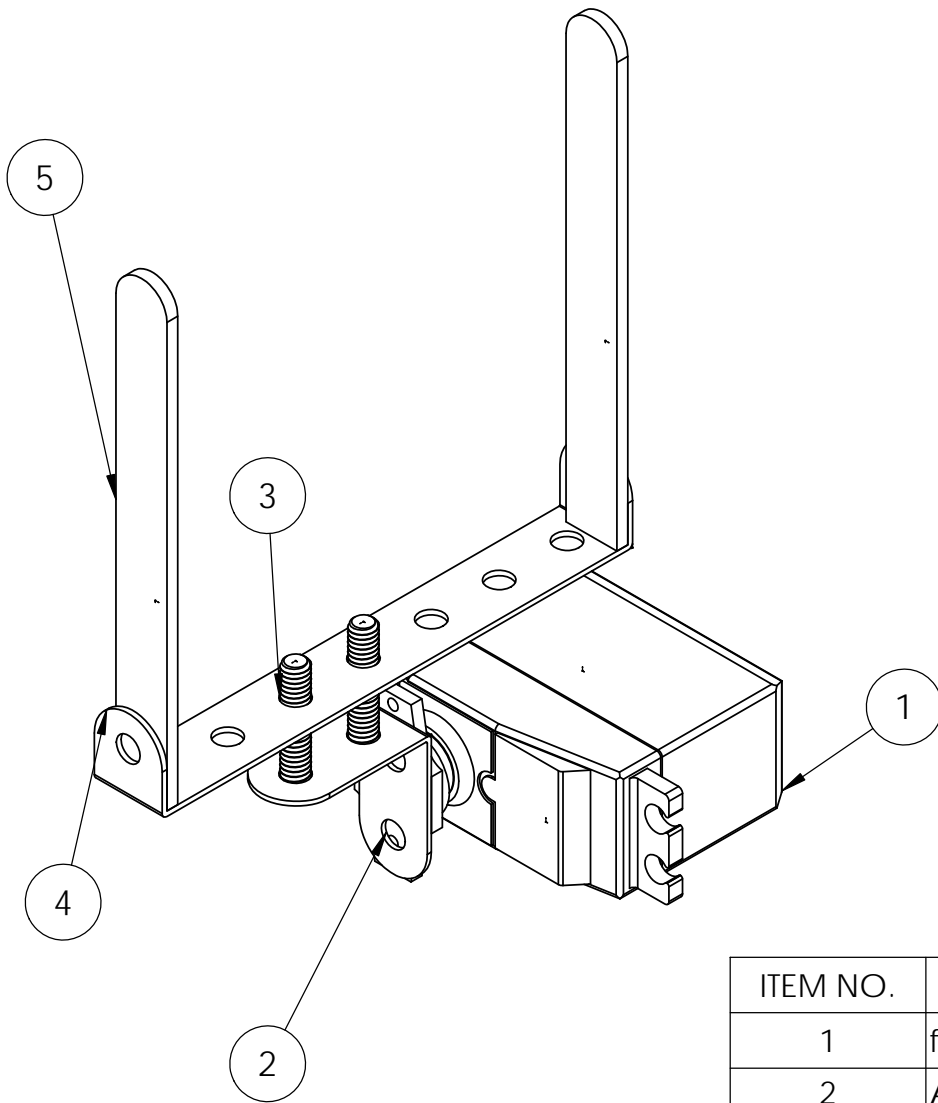

ITEM NO.	PART NUMBER	DESCRIPTION	QTY.
1	futabaServo For Arms	STEEL	1
2	Angle Bracket 2x2	STEEL	1
3	SCREW04	STEEL	2
4	Double Angle Strip 1x7x1	STEEL	1
5	Popsicle Stick	PLYWOOD	2

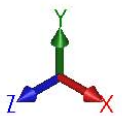
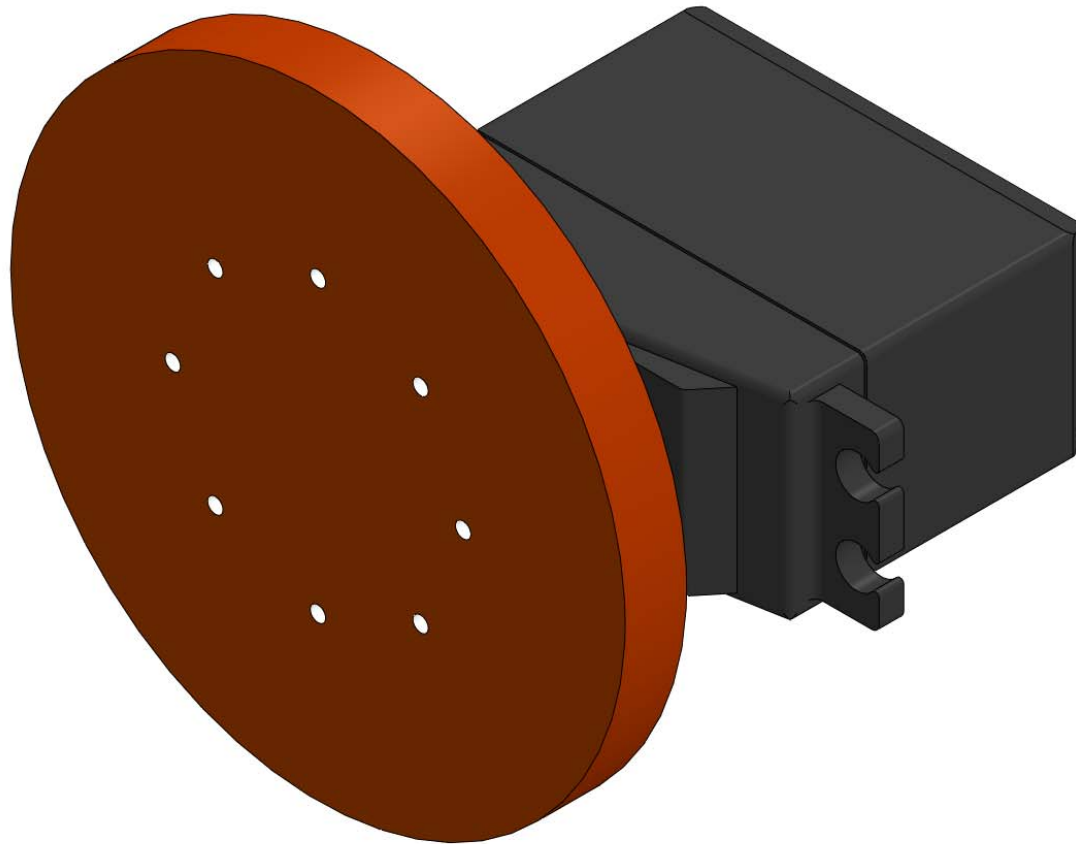

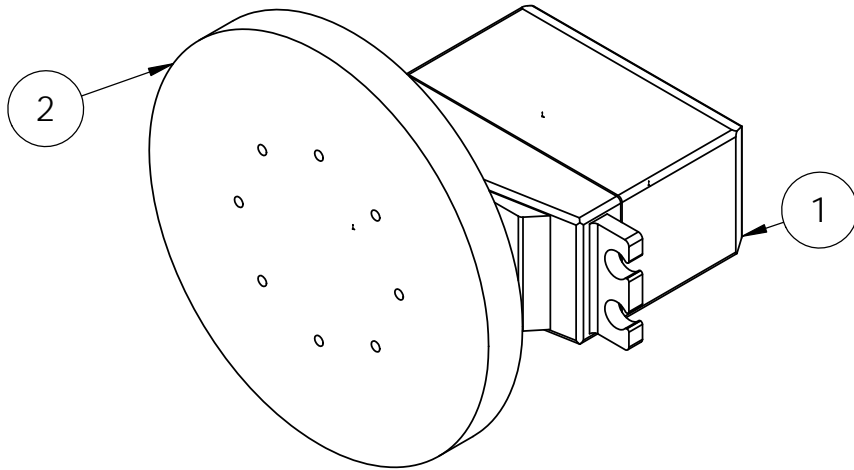

ITEM NO.	PART NUMBER	DESCRIPTION	QTY.
1	futabaServo For Crank	STEEL	1
2	3D Printed Crank Wheel	ABS PLASTIC	1

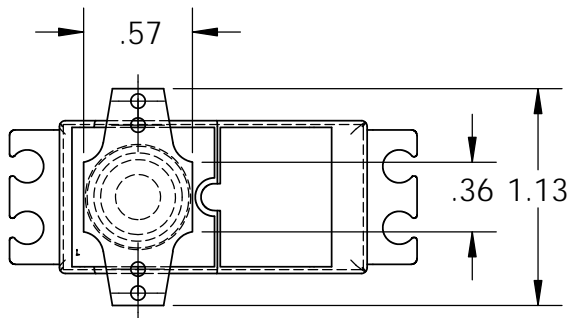
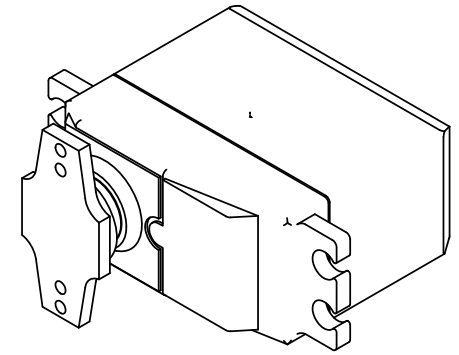
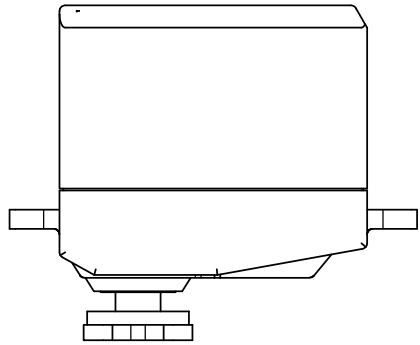

The modification of the servo motor consisted of removing edges from the face of the motor. Cutting off some of the face allowed for better connection, and the ability to achieve full range of motion without colliding with main body.

